

PARKLAND COUNTY  
PROVINCE OF ALBERTA

BYLAW 2018-02

BEING A BYLAW OF PARKLAND COUNTY FOR THE PURPOSE OF  
AMENDING SCHEDULE "A" (LAND USE DISTRICT MAP 5) and SCHEDULE "D" (WHITEWOOD  
DIRECT CONTROL DISTRICT MAP) OF LAND USE BYLAW 2017-18

**WHEREAS** the *Municipal Government Act*, RSA 2000, Chapter M-26 authorizes Council to pass bylaws for municipal purposes respecting planning authorities within Parkland County; and

**WHEREAS** Council of Parkland County wishes to pass a bylaw for the purpose of regulating and controlling the use and development of land and buildings; and

**WHEREAS** the Council of Parkland County has passed a Bylaw pursuant to Part 17, Section 639 of the Municipal Government Act, R.S.A. 2000, Chapter M-26, known as the Parkland County Land Use Bylaw 2017-18 for the purpose of regulating and controlling the use and development of land and buildings within Parkland County;

**WHEREAS** and pursuant to Part 17, Section 692 of the Municipal Government Act, R.S.A. 2000, Chapter M-26, the Council of a municipality is authorized to amend a Land Use Bylaw;

**WHEREAS** Section 692 of the Municipal Government Act requires the Council of a municipality to hold a public hearing and advertise such a Bylaw in accordance with Sections 230 and Section 606 of the Act respectively; and

**WHEREAS** this bylaw is advertised in accordance with Section 606 of the Municipal Government Act, and a public hearing is held in accordance with Section 230 of the Municipal Government Act.

**NOW THEREFORE** the Council of Parkland County, duly assembled and under the authority of the *Municipal Government Act*, as amended, hereby enacts the following:

**TITLE**

1. This bylaw shall be known as the "Whitewood Mine Redistricting Bylaw".

**DEFINITIONS**

2. The following definitions will apply to the corresponding words in this bylaw:
- (1) "County" means the Municipality of Parkland County in the Province of Alberta.
- (2) "Council" means the council of the County.

**INTERPRETATION**

3. The headings in this bylaw are for reference purposes only.

**BYLAW 2017-18 AMENDMENTS:**

4. That Land Use District Map 5 in Schedule A of Land Use Bylaw 2017-18, and amendments thereto, is amended by redistricting approximately 1634 ha (4,037 ac) of land as follows:

Short Legal	Long Legal	Existing Land Use District	Proposed Land Use District	Area of Redistricting (approximate)
5;4;53;15;NW	MERIDIAN 5; RANGE 4; TOWNSHIP 53; SECTION 15 QUARTER NORTH WEST	RE-Resource Extraction District	AGG - Agriculture General District	13.24 ha <del>49.51 ha</del> 62.78 ha
5;4;53;15;NE	MERIDIAN 5; RANGE 4; TOWNSHIP 53; SECTION 15 QUARTER NORTH EAST	RE-Resource Extraction District	ANC - Agriculture/Nature Conservation District	58.73 ha
			AGG - Agriculture General District	4.8 ha
5;4;53;15;SW	MERIDIAN 5; RANGE 4 TOWNSHIP 53; SECTION 15 QUARTER SOUTH WEST	RE-Resource Extraction District	AGG - Agriculture General District	8.6 ha 30.13 ha <del>13.36 ha</del> 52.09 ha

5;4;53;15;SE	MERIDIAN 5; RANGE 4 TOWNSHIP 53; SECTION 15 QUARTER SOUTH EAST	RE-Resource Extraction District	AGG - Agriculture General District	6.65 ha 42.59 ha <u>1.19 ha</u> 50.43 ha
			ANC - Agriculture/Nature Conservation District	2.04 ha
5;4;53;16;NW	MERIDIAN 5; RANGE 4; TOWNSHIP 53; SECTION 16 QUARTER NORTH WEST	RE-Resource Extraction District	AGG - Agriculture General District	13.83 ha <u>30.13 ha</u> 43.96 ha
5;4;53;16;NE	MERIDIAN 5; RANGE 4; TOWNSHIP 53; SECTION 16 QUARTER NORTH EAST	RE-Resource Extraction District	ANC - Agriculture/Nature Conservation District	48.79 ha
			AGG - Agriculture General District	13.09 ha
5;4;53;16;SE	MERIDIAN 5; RANGE 4; TOWNSHIP 53; SECTION 16 QUARTER SOUTH EAST	RE-Resource Extraction District	AGG - Agriculture General District	13.97 ha
5;4;53;17;NE	MERIDIAN 5; RANGE 4; TOWNSHIP 53; SECTION 17 PORTION OF THE NORTH EAST QUARTER	RE-Resource Extraction District	PC - Conservation District	11.03 ha <u>1.23 ha</u> 12.26 ha
5;4;53;19;NE	MERIDIAN 5; RANGE 4; TOWNSHIP 53; SECTION 19 QUARTER NORTH EAST	AGG - Agriculture General District	PC - Conservation District	67.70 ha
5;4;53;20;NW	MERIDIAN 5; RANGE 4; TOWNSHIP 53; SECTION 20 QUARTER NORTH WEST	RE-Resource Extraction District	PC - Conservation District	61.82 ha
5;4;53;20;NE	MERIDIAN 5; RANGE 4; TOWNSHIP 53; SECTION 20 PORTION OF THE NORTH EAST QUARTER	RE-Resource Extraction District	PC - Conservation District	19.95 ha <u>3.55 ha</u> 23.50 ha
			ANC - Agriculture/ Nature Conservation District	38.23 ha
5;4;53;20;SW	MERIDIAN 5; RANGE 4; TOWNSHIP 53; SECTION 20 QUARTER SOUTH WEST	RE-Resource Extraction District	PC - Conservation District	51.78 ha <u>0.58 ha</u> 52.36 ha
5;4;53;20;SE,	MERIDIAN 5; RANGE 4; TOWNSHIP 53; SECTION 20 QUARTER SOUTH EAST AND PORTIONS OF THE EAST HALF COMPRISING THE BED AND SHORE OF WHITEWOOD LAKE AND LAKE A	RE-Resource Extraction District	PC - Conservation District	42.74 ha <u>3.91 ha</u> 46.65 ha 25.79 ha (lake)
5;4;53;21;NW	MERIDIAN 5; RANGE 4; TOWNSHIP 53; SECTION 21 NORTH WEST QUARTER	RE-Resource Extraction District	ANC - Agriculture/Nature Conservation District	41.40 ha 10.78 ha (lake)
			AGG - Agriculture General District	8.42 ha
5;4;53;21;NE	MERIDIAN 5; RANGE 4; TOWNSHIP 53; SECTION 21 PORTION OF THE NORTH EAST QUARTER	RE-Resource Extraction District	ANC - Agriculture/Nature Conservation District	52.11 ha 11.58 ha (lake)
			AGG - Agriculture General District	0.34 ha
5;4;53;21;SW	MERIDIAN 5; RANGE 4; TOWNSHIP 53; SECTION 21 ALL THAT PORTION OF THE SOUTH WEST QUARTER	RE-Resource Extraction District	AGG - Agriculture General District	52.76 ha 11.44 ha (lake)
5;4;53;21;SE	MERIDIAN 5; RANGE 4; TOWNSHIP 53; SECTION 21 QUARTER SOUTH EAST	RE-Resource Extraction District	ANC - Agriculture/Nature Conservation District	17.40 ha 30.06 ha
			AGG - Agriculture General District	14.13 ha
5;4;53;22;NW	MERIDIAN 5; RANGE 4; TOWNSHIP 53; SECTION 22 QUARTER NORTH WEST	RE-Resource Extraction District	PC - Conservation District	16.31 ha
			ANC - Agriculture/Nature Conservation District	48.55 ha
5;4;53;22;SW	MERIDIAN 5; RANGE 4; TOWNSHIP 53; SECTION 22 QUARTER SOUTH WEST	RE-Resource Extraction District	ANC - Agriculture/Nature Conservation District	30.56 ha
			AGG - Agriculture General District	30.20 ha
5;4;53;22;SE	MERIDIAN 5; RANGE 4; TOWNSHIP 53; SECTION 22 QUARTER SOUTH EAST	RE-Resource Extraction District	ANC - Agriculture/Nature Conservation District	48.21 ha
			AGG - Agriculture General District	16.67 ha

5;4;53;27;SW	MERIDIAN 5; RANGE 4; TOWNSHIP 53; SECTION 27 QUARTER SOUTH WEST	RE-Resource Extraction District	PC - Conservation District	24.97 ha
5;4;53;28;NW	MERIDIAN 5; RANGE 4; TOWNSHIP 53; SECTION 28 QUARTER NORTH WEST	RE-Resource Extraction District	PC - Conservation District	13.21 ha
5;4;53;28;SW	MERIDIAN 5; RANGE 4; TOWNSHIP 53; SECTION 28 PORTIONS OF THE SOUTH WEST QUARTER	RE-Resource Extraction District	PC - Conservation District	33.40 ha
			ANC - Agriculture/Nature Conservation District	30.98 ha
5;4;53;28;SE	MERIDIAN 5; RANGE 4; TOWNSHIP 53; SECTION 28 PORTIONS OF THE SOUTH EAST QUARTER	RE-Resource Extraction District	PC - Conservation District	62.11 ha 2.38 ha (lake)
5;4;53;29;NW	MERIDIAN 5; RANGE 4; TOWNSHIP 53; SECTION 29 QUARTER NORTH WEST	RE-Resource Extraction District	PC - Conservation District	20.43 ha
5;4;53;29;NE	MERIDIAN 5; RANGE 4; TOWNSHIP 53; SECTION 29 QUARTER NORTH EAST	RE-Resource Extraction District	PC - Conservation District	20.11 ha
5;4;53;29;SW	MERIDIAN 5; RANGE 4; TOWNSHIP 53; SECTION 29 QUARTER SOUTH WEST	RE-Resource Extraction District	PC - Conservation District	63.56 ha <u>0.54 ha</u> 64.10 ha
5;4;53;29;SE	MERIDIAN 5; RANGE 4; TOWNSHIP 53; SECTION 29 QUARTER SOUTH EAST	RE-Resource Extraction District	PC - Conservation District	33.83 ha
			ANC - Agriculture/Nature Conservation District	30.94 ha
5;4;53;30;NW	MERIDIAN 5; RANGE 4; TOWNSHIP 53; SECTION 30 QUARTER NORTH WEST	AGG - Agriculture General District	PC - Conservation District	24.89 ha
5;4;53;30;NE	MERIDIAN 5; RANGE 4; TOWNSHIP 53; SECTION 30 QUARTER NORTH EAST	AGG - Agriculture General District	PC - Conservation District	20.66 ha
5;4;53;30;SW	MERIDIAN 5; RANGE 4; TOWNSHIP 53; SECTION 30 QUARTER SOUTH WEST	AGG - Agriculture General District	PC - Conservation District	11.84 ha <u>51.40 ha</u> 63.24 ha
5;4;53;30;SE	MERIDIAN 5; RANGE 4; TOWNSHIP 53; SECTION 30 QUARTER SOUTH EAST	AGG - Agriculture General District	PC - Conservation District	64.34 ha
Total Areas to be Redistricted:		AGG - Agriculture General District	PC - Conservation District	240.83 ha
		RE-Resource Extraction District	AGG - Agriculture General District	378.03 ha
		ANC - Agriculture/ Nature Conservation District	ANC - Agriculture/Nature Conservation District	500.37 ha
		ANC - Agriculture/ Nature Conservation District	ANC - Agriculture/Nature Conservation District	514.40 ha

as shown on attached Schedule "A", attached to and forming part of this Bylaw.

5.
- That Land Use District Map 5 in Schedule A and Whitewood Direct Control District Map in Schedule D of Land Use Bylaw 2017-18, and amendments thereto, is amended by removing the following approximately 1378 ha (3,405 ac) of land from the Whitewood Direct Control District (DC Area 3) as follows:

Short Legal	Long Legal	Approximate Area to be Removed from the Whitewood Direct Control District
5;4;53;15;NW	MERIDIAN 5; RANGE 4; TOWNSHIP 53; SECTION 15 QUARTER NORTH WEST	62.48 ha
5;4;53;15;NE	MERIDIAN 5; RANGE 4; TOWNSHIP 53; SECTION 15 QUARTER NORTH EAST	63.53 ha

5;4;53;15;SW	MERIDIAN 5; RANGE 4 TOWNSHIP 53; SECTION 15 QUARTER SOUTH WEST	52.09 ha
5;4;53;15;SE	MERIDIAN 5; RANGE 4 TOWNSHIP 53; SECTION 15 QUARTER SOUTH EAST	52.47 ha
5;4;53;16;NW	MERIDIAN 5; RANGE 4; TOWNSHIP 53; SECTION 16 QUARTER NORTH WEST	43.96 ha
5;4;53;16;NE	MERIDIAN 5; RANGE 4; TOWNSHIP 53; SECTION 16 QUARTER NORTH EAST	61.88 ha
5;4;53;16;SE	MERIDIAN 5; RANGE 4; TOWNSHIP 53; SECTION 16 QUARTER SOUTH EAST	13.97 ha
5;4;53;17;NE	MERIDIAN 5; RANGE 4; TOWNSHIP 53; SECTION 17 PORTION OF THE NORTH EAST QUARTER	12.26 ha
5;4;53;20;NW	MERIDIAN 5; RANGE 4; TOWNSHIP 53; SECTION 20 QUARTER NORTH WEST	61.82 ha
5;4;53;20;NE	MERIDIAN 5; RANGE 4; TOWNSHIP 53; SECTION 20 PORTION OF THE NORTH EAST QUARTER	61.73 ha
5;4;53;20;SW	MERIDIAN 5; RANGE 4; TOWNSHIP 53; SECTION 20 QUARTER SOUTH WEST	52.36 ha
5;4;53;20;SE,	MERIDIAN 5; RANGE 4; TOWNSHIP 53; SECTION 20 QUARTER SOUTH EAST AND PORTIONS OF THE EAST HALF COMPRISING THE BED AND SHORE OF WHITEWOOD LAKE AND LAKE A	46.65 ha 25.79 ha (lake)
5;4;53;21;NW	MERIDIAN 5; RANGE 4; TOWNSHIP 53; SECTION 21 NORTH WEST QUARTER	49.82 ha 10.78 ha (lake)
5;4;53;21;NE	MERIDIAN 5; RANGE 4; TOWNSHIP 53; SECTION 21 PORTION OF THE NORTH EAST QUARTER	52.45 ha 11.58 ha (lake)
5;4;53;21;SW	MERIDIAN 5; RANGE 4; TOWNSHIP 53; SECTION 21 ALL THAT PORTION OF THE SOUTH WEST QUARTER	52.76 ha 11.44 ha (lake)
5;4;53;21;SE	MERIDIAN 5; RANGE 4; TOWNSHIP 53; SECTION 21 QUARTER SOUTH EAST	61.59 ha
5;4;53;22;NW	MERIDIAN 5; RANGE 4; TOWNSHIP 53; SECTION 22 QUARTER NORTH WEST	64.86 ha
5;4;53;22;SW	MERIDIAN 5; RANGE 4; TOWNSHIP 53; SECTION 22 QUARTER SOUTH WEST	30.56 ha 30.20 ha
5;4;53;22;SE	MERIDIAN 5; RANGE 4; TOWNSHIP 53; SECTION 22 QUARTER SOUTH EAST	48.21 ha 16.67 ha
5;4;53;27;SW	MERIDIAN 5; RANGE 4; TOWNSHIP 53; SECTION 27 QUARTER SOUTH WEST	24.97 ha
5;4;53;28;SW	MERIDIAN 5; RANGE 4; TOWNSHIP 53; SECTION 28 PORTIONS OF THE SOUTH WEST QUARTER	64.38 ha
5;4;53;28;SE	MERIDIAN 5; RANGE 4; TOWNSHIP 53; SECTION 28 PORTIONS OF THE SOUTH EAST QUARTER	62.11 ha 2.38 ha (lake)
5;4;53;29;NW	MERIDIAN 5; RANGE 4; TOWNSHIP 53; SECTION 29 QUARTER NORTH WEST	20.43 ha
5;4;53;29;NE	MERIDIAN 5; RANGE 4; TOWNSHIP 53; SECTION 29 QUARTER NORTH EAST	20.11 ha
5;4;53;29;SW	MERIDIAN 5; RANGE 4; TOWNSHIP 53; SECTION 29 QUARTER SOUTH WEST	64.10 ha
5;4;53;29;SE	MERIDIAN 5; RANGE 4; TOWNSHIP 53; SECTION 29 QUARTER SOUTH EAST	67.77 ha

as shown on attached Schedule “B”, attached to and forming part of this Bylaw.

**ENACTMENT/TRANSITION**

6. Should any provision of this bylaw be deemed invalid then such invalid provision will be severed from this bylaw and such severance will not affect the validity of the remaining portions of this bylaw, except to the extent necessary to give effect to such severance.
7. Schedule “A” and Schedule “B” forms part of this bylaw.
8. This bylaw shall come into force and take effect on the day of third reading and signing thereof.

**READ A FIRST TIME** this \_\_\_\_\_ day of \_\_\_\_\_, 2018.

**READ A SECOND TIME** this \_\_\_\_\_ day of \_\_\_\_\_, 2018.

**READ A THIRD TIME** and finally passed this \_\_\_\_\_ day of \_\_\_\_\_, 2018.

**SIGNED AND PASSED** this \_\_\_\_\_ day of \_\_\_\_\_, 2018.

\_\_\_\_\_  
Mayor

\_\_\_\_\_  
Chief Administrative Officer

SCHEDULE A

TO WHITEWOODS MINE REDISTRICTING BYLAW 2018-02

Redistricting Map for the Whitewood Mine Area

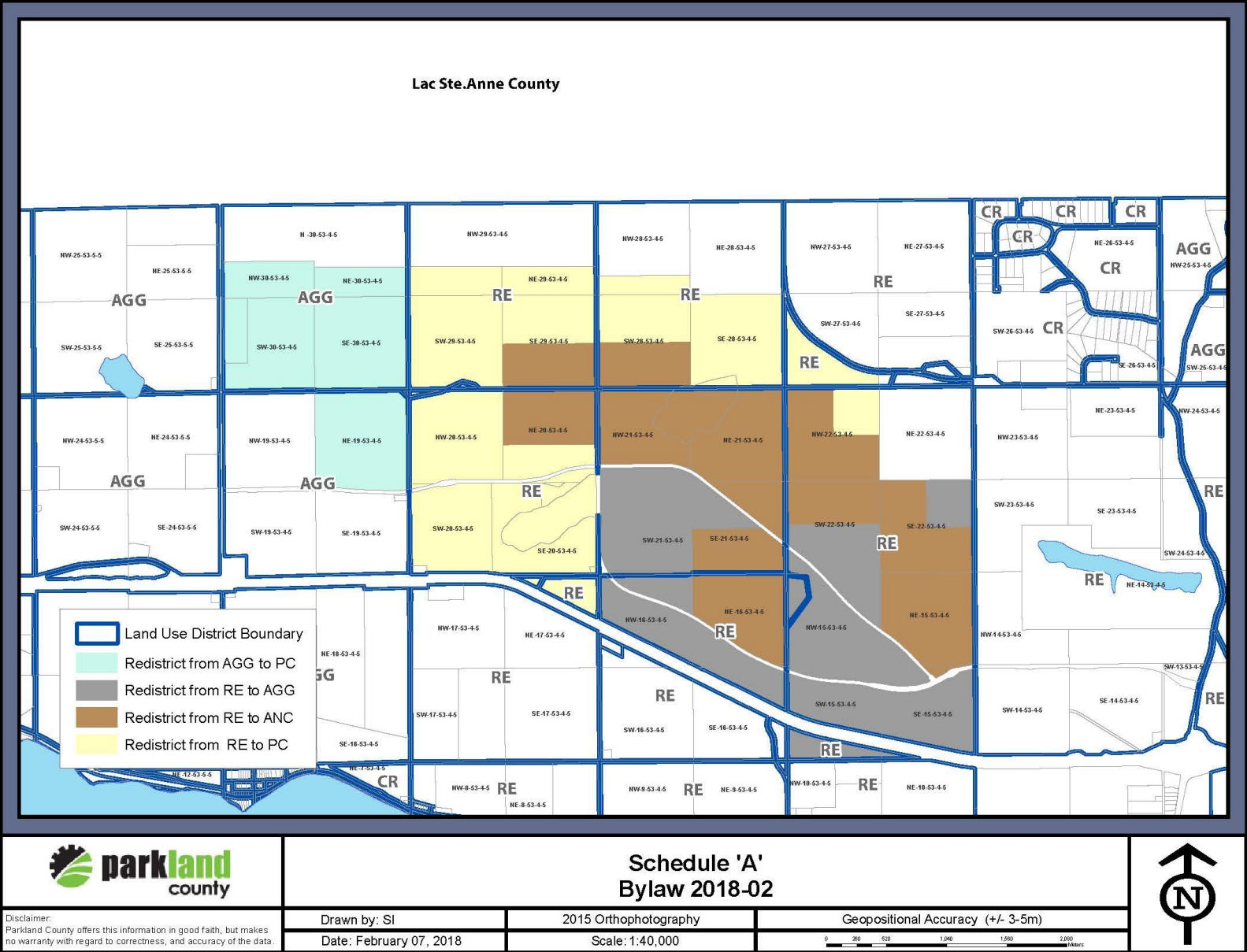

## SCHEDULE B

**TO WHITEWOODS MINE REDISTRICTING BYLAW 2018-02**

### Removal of Lands from the Whitewood Direct Control District

