

Spruce Grove Specialized Transit Service

c/o 315 Jespersen Avenue, Spruce Grove, Alberta T7X 3E8 Phone 962-2456

RECEIVED

JUN 13 2012

PARKLAND COUNTY
LEG. & ADMIN

May 25, 2012

Manager of Legislative and Administrative Services
Parkland County, 53109 Hwy 779
Parkland County, AB
T7Z 1R1

Re: Seniors and Disabled Transportation Grant

Once again the Specialized Transit Service is requesting assistance in meeting our 2012 Operational Funding goals. The ongoing support the County of Parkland has provided us continues to allow us to meet the transportation needs of those slightly less fortunate in the City of Spruce Grove and the limited area we service in the County of Parkland.

Over the previous year we have noticed an increase in the request for information pertaining to our availability and access from residence of the County. Although this interest resulted in only a few new clients it has been an encouragement to us of the potential that may exist there. This past year saw us replace our older twenty (20) seat bus with a new one. This acquisition has allowed us to increase our local shopping to two (2) days Tuesday and Thursday each week.

We continue to see increases in the number of trips to the City of Edmonton for various medical treatments and to allow our clients to see various specialists. These trips result in increased millage on our units and increase labor costs for our drivers. We were forced to request an addition increase from the City of Spruce Grove this year to correct what appeared to be an ongoing shortfall in specific areas of our Operating Budget over the past couple of years. As in the past, the City stepped forward and increased their grant to accommodate our request. A request of an additional \$500.00 to your \$9,500.00 2011 grant to \$10,000.00 would go a long way in allowing us to keep pace with these ongoing increases.

In closing, I wish to thank you in advance on behalf of all our present and future clients for your ongoing and timely support. Your humanitarian consideration of the needs of a very select segment of our society is evident in this gift.

Should you require any additional information regarding STS, please contact Bonnie Foster at (780) 962-2456, or myself at (780) 962-3829.

Please find attached a copy of our Financial Audit, and Business Plan.

Sincerely,



Sid Davis, President
Spruce Grove Specialized Transit Service

SD/bf

**SPECIALIZED TRANSPORTATION GRANTS
FOR SENIORS AND DISABLED PERSONS**

APPLICATION FOR FUNDING

Name of Association, Society or Group: Spruce Grove Specialized Transit Service

Are you registered with the Province of Alberta as a non-profit organization? Yes

Address: c/o 315 Jespersen Avenue, Spruce Grove, AB T7X 3E8

Contact Person (position/title): Bonnie Foster/STS Office Manager

Telephone Number: 780-962-2456 Fax Number: 780-962-9501
Cell Number: _____ E-Mail: sts.bonnie@shaw.ca

Purpose of Goals of Association, Society, or Group: To provide transportation service for essential medical and social services at a reasonable cost for Seniors (55+) and persons with mobility challenges in Spruce Grove and delineated Parkland County Areas.

Reason for Request for Funding: Funding for operational costs for the year 2012.

Number of People Served by Association, Society, or Group: 706 Registered Applicants

Number of Parkland County People Served: 57 Registered Clients

Please attach:

1. Financial Statement and/or Budget that indicates revenues and expenditures.
2. Map of Parkland County indicating your service area.

May 25, 2012
Date

[Signature] STS Office Manager
Signature

Please forward completed form and attachments to Manager of Legislative and Administrative Services,
Parkland County, 53109 Hwy 779, Parkland County, AB T7Z 1R1. Applications **must be received by June 30th**.
For further information, please contact Jennifer McAdam at 780-968-3228.



STS provides service for:
East of the Fifth Meridian
North of 627, South of TSP Rd 540
and west of Hwy 60

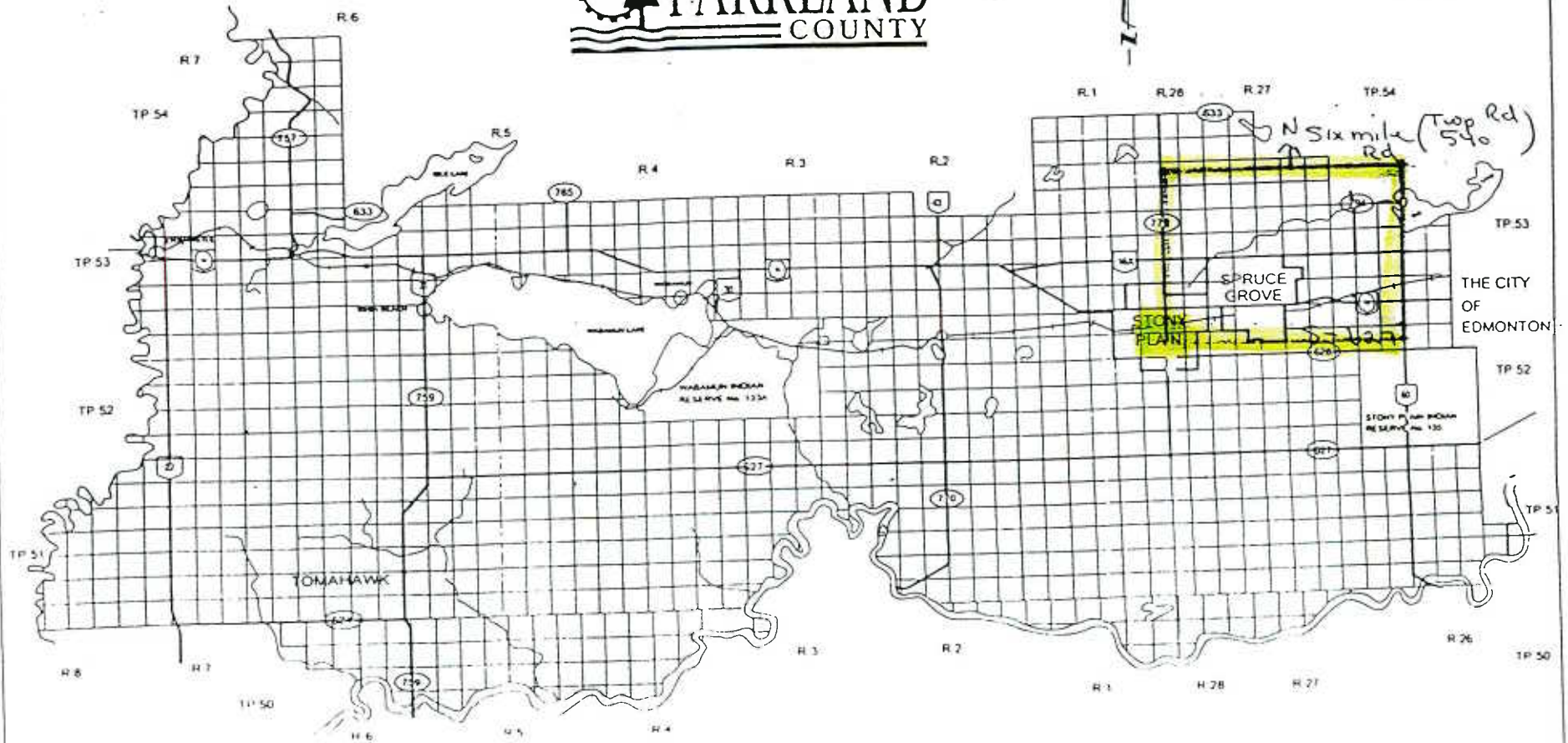

SPRUCE GROVE SPECIALIZED TRANSIT SERVICE

Spruce Grove, Alberta

Financial Statements

For The Year Ended December 31, 2011

SPRUCE GROVE SPECIALIZED TRANSIT SERVICE
Statement of Financial Position
As At December 31, 2011

	2011	2010
ASSETS		
CURRENT		
Cash (<i>Note 3</i>)	\$ 158,556	\$ 151,279
Goods and Services Tax recoverable	680	747
	<u>159,236</u>	<u>152,026</u>
LONG TERM INVESTMENTS	<u>1,814</u>	<u>1,741</u>
	<u>\$ 161,050</u>	<u>\$ 153,767</u>
LIABILITIES AND NET ASSETS		
CURRENT		
Accounts payable and accrued liabilities	\$ 8,650	\$ 5,410
NET ASSETS		
Unrestricted	<u>152,400</u>	<u>148,357</u>
	<u>\$ 161,050</u>	<u>\$ 153,767</u>

ON BEHALF OF THE BOARD:

_____ *Director*

_____ *Director*

The accompanying notes are an integral part of these financial statements.

SPRUCE GROVE SPECIALIZED TRANSIT SERVICE
Statement of Operations
For The Year Ended December 31, 2011

	Budget 2011	2011	2010
REVENUE			
Grants	\$ 113,500	\$ 113,500	\$ 108,200
Fares	39,000	39,005	35,178
Donations	5,200	6,440	7,450
Interest	2,000	1,582	891
Miscellaneous	-	155	180
	<u>159,700</u>	<u>160,682</u>	<u>151,899</u>
EXPENSES			
Contract labour	87,000	91,893	85,084
Salaries, wages and benefits	37,000	35,485	32,735
Fuel	15,000	14,479	14,997
Professional fees	8,000	3,488	3,071
Office	4,300	3,257	2,198
Telephone	3,200	2,962	2,656
Workers' Compensation Board	2,000	1,391	1,418
Insurance	1,500	1,185	1,167
Advertising and promotion	1,700	889	210
Miscellaneous	-	813	569
Utilities	-	694	659
Interest and bank charges	-	103	49
Consulting fees	-	-	4,558
	<u>159,700</u>	<u>156,639</u>	<u>149,371</u>
EXCESS OF REVENUE OVER EXPENSES	<u>\$ -</u>	<u>\$ 4,043</u>	<u>\$ 2,528</u>

SPRUCE GROVE SPECIALIZED TRANSIT SERVICE
Statement of Changes in Net Assets
For The Year Ended December 31, 2011

	2011	2010
NET ASSETS - BEGINNING OF YEAR	\$ 148,357	\$ 145,829
Excess of revenue over expenses	<u>4,043</u>	<u>2,528</u>
NET ASSETS - END OF YEAR	<u>\$ 152,400</u>	<u>\$ 148,357</u>

The accompanying notes are an integral part of these financial statements.

SPRUCE GROVE SPECIALIZED TRANSIT SERVICE
Statement of Cash Flows
For The Year Ended December 31, 2011

	2011	2010
OPERATING ACTIVITIES		
Excess of revenue over expenses	\$ 4,043	\$ 2,528
Changes in non-cash working capital:		
Accounts receivable	-	27
Accounts payable and accrued liabilities	3,240	1,038
Goods and Services Tax receivable	67	(282)
	<u>3,307</u>	<u>783</u>
Cash flow from operating activities	<u>7,350</u>	<u>3,311</u>
INVESTING ACTIVITY		
Increase in Servus Credit Union Common Shares	<u>(73)</u>	<u>(75)</u>
INCREASE IN CASH FLOW	<u>7,277</u>	<u>3,236</u>
CASH - BEGINNING OF YEAR	<u>151,279</u>	<u>148,043</u>
CASH - END OF YEAR (Note 3)	<u>\$ 158,556</u>	<u>\$ 151,279</u>
CASH FLOWS SUPPLEMENTARY INFORMATION		
Interest received	<u>\$ 1,504</u>	<u>\$ 886</u>