



---

**BYLAW 2025-05  
ACHESON INDUSTRIAL AREA STRUCTURE PLAN AMENDMENT**

**PARKLAND COUNTY COUNCIL**

**FIRST READING  
FEBRUARY 11, 2025**

# Amending the Acheson Industrial Area Structure Plan to amend lands presented below from 'Constrained Lands' to 'Commercial/Light Industrial'

The map displays the Spruce Grove area, including the Wagner Natural Area (green) and various residential and commercial zones (pink, yellow, orange, and grey). Key roads shown include 114 Avenue, 108 Avenue, 96 Avenue, 92 Avenue, 244 Street, 266 Street, 280 Street, 284 Street, 288 Street, 292 Street, 296 Street, 300 Street, 304 Street, 308 Street, 312 Street, 316 Street, 320 Street, 324 Street, 328 Street, 332 Street, 336 Street, 340 Street, 344 Street, 348 Street, 352 Street, 356 Street, 360 Street, 364 Street, 368 Street, 372 Street, 376 Street, 380 Street, 384 Street, 388 Street, 392 Street, 396 Street, 400 Street, 404 Street, 408 Street, 412 Street, 416 Street, 420 Street, 424 Street, 428 Street, 432 Street, 436 Street, 440 Street, 444 Street, 448 Street, 452 Street, 456 Street, 460 Street, 464 Street, 468 Street, 472 Street, 476 Street, 480 Street, 484 Street, 488 Street, 492 Street, 496 Street, 500 Street, 504 Street, 508 Street, 512 Street, 516 Street, 520 Street, 524 Street, 528 Street, 532 Street, 536 Street, 540 Street, 544 Street, 548 Street, 552 Street, 556 Street, 560 Street, 564 Street, 568 Street, 572 Street, 576 Street, 580 Street, 584 Street, 588 Street, 592 Street, 596 Street, 600 Street, 604 Street, 608 Street, 612 Street, 616 Street, 620 Street, 624 Street, 628 Street, 632 Street, 636 Street, 640 Street, 644 Street, 648 Street, 652 Street, 656 Street, 660 Street, 664 Street, 668 Street, 672 Street, 676 Street, 680 Street, 684 Street, 688 Street, 692 Street, 696 Street, 700 Street, 704 Street, 708 Street, 712 Street, 716 Street, 720 Street, 724 Street, 728 Street, 732 Street, 736 Street, 740 Street, 744 Street, 748 Street, 752 Street, 756 Street, 760 Street, 764 Street, 768 Street, 772 Street, 776 Street, 780 Street, 784 Street, 788 Street, 792 Street, 796 Street, 800 Street, 804 Street, 808 Street, 812 Street, 816 Street, 820 Street, 824 Street, 828 Street, 832 Street, 836 Street, 840 Street, 844 Street, 848 Street, 852 Street, 856 Street, 860 Street, 864 Street, 868 Street, 872 Street, 876 Street, 880 Street, 884 Street, 888 Street, 892 Street, 896 Street, 900 Street, 904 Street, 908 Street, 912 Street, 916 Street, 920 Street, 924 Street, 928 Street, 932 Street, 936 Street, 940 Street, 944 Street, 948 Street, 952 Street, 956 Street, 960 Street, 964 Street, 968 Street, 972 Street, 976 Street, 980 Street, 984 Street, 988 Street, 992 Street, 996 Street, 1000 Street. The map also shows the location of the Wagner Natural Area, the Spruce Grove area, and the surrounding municipalities of Spruce Grove, Edmonton, and Enoch Cree Nation. A north arrow is located in the top right corner.

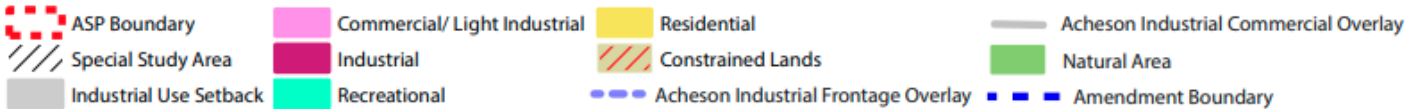

# ADMINISTRATION RECOMMENDATIONS

1. That Bylaw 2025-05 receive first reading
2. That a Public Hearing be scheduled for March 11, 2025, at 9:30 am in Council Chambers to hear public comment on Bylaw 2025-05



---

**BYLAW 2025-06**  
**S.W. 29-52-26-4 AND LOT 1 AND 2, BLOCK 1, PLAN 032 1486**  
**REDISTRICTING BYLAW**

**PARKLAND COUNTY COUNCIL**

**FIRST READING**  
**FEBRUARY 11, 2025**

# INTENT

## Redistricting of lands from AGR-Agriculture Restricted to BI-Business Industrial

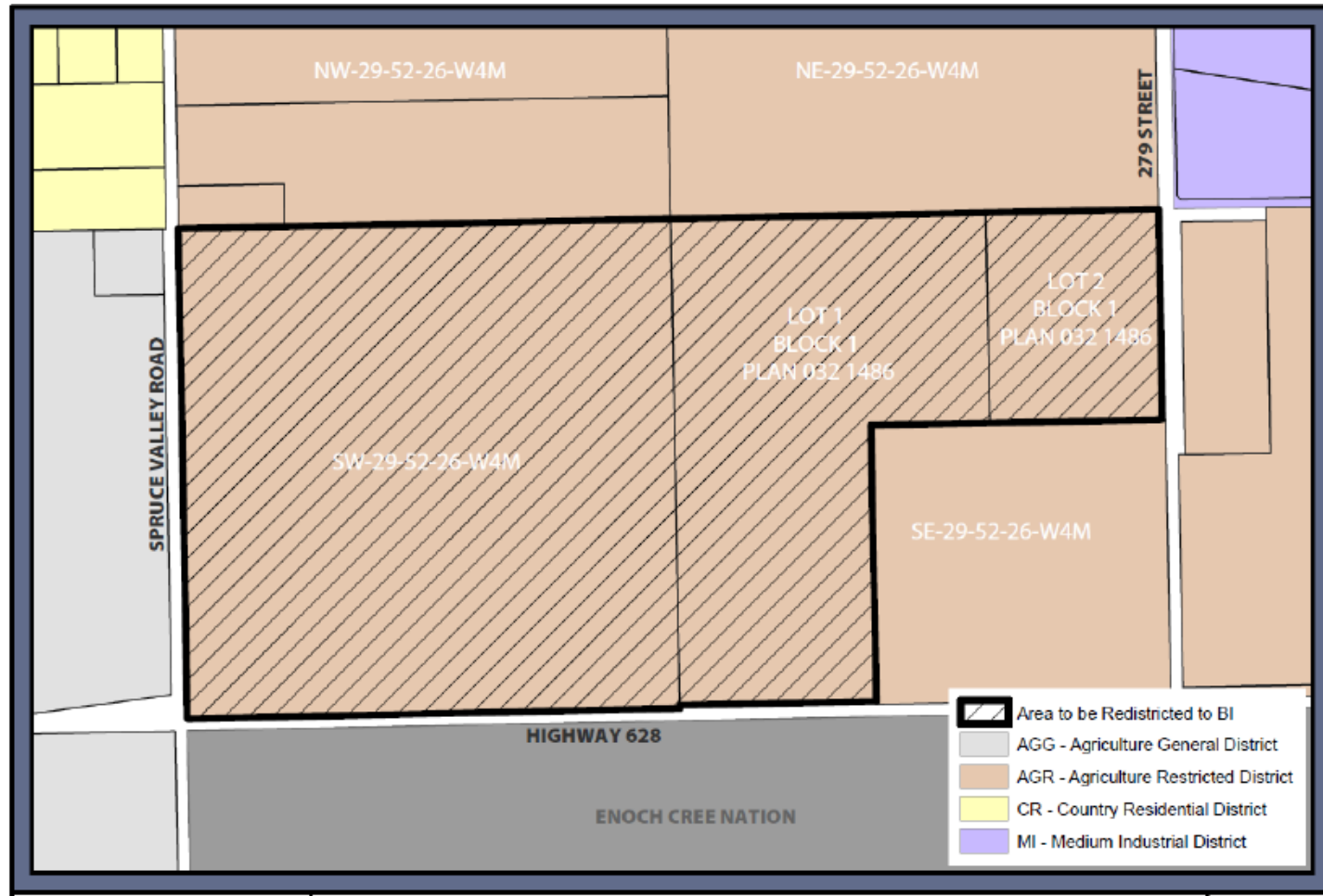

# ADMINISTRATION RECOMMENDATIONS

1. That Bylaw 2025-06 receive first reading
2. That a Public Hearing be scheduled for March 11, 2025, at 10:00 am in Council Chambers to hear public comment on Bylaw 2025-06