

EVANSBURG & ENTWISTLE CHAMBER OF COMMERCE
"PARTNERS ON THE PEMBINA"

BOX 598 EVANSBURG, AB. T0E 0T0 ph/fax 780-727-3526

Email: partnersonthepembina@gmail.com

March 10, 2017

Karen Oxley, Planner
Planning and Development Services
53109A Hwy 779
Parkland County, AB
T7Z 1R1

Dear Sirs:

RE: Proposed Bylaws No. 2017-03 and 2017-04

The Evansburg and Entwistle Chamber of Commerce would like to submit our support to the proposed development of a wood pellet processing facility in Entwistle.

Our community has endured many years of waiting for investors to realize the potential of our location as a transport corridor. The Entwistle area enjoys access to main highways leading in all directions. The proximity to a main railway line to the west coast is one of our greatest assets. For this very reason, the company planning this development has chosen our area.

As a chamber, we recognize the positive attributes this development can bring to our communities. The prospects of jobs during the initial construction and the permanent jobs created thereafter will have a huge impact on our economy. These jobs are critical to invigorating the health of businesses in and around Entwistle and Evansburg. Employed citizens will spend in the local economy. As well, local businesses will enjoy the spinoffs of the construction, operation and maintenance of this operation.

This development will have an impact on our community besides a business's bottom line. Employees may choose to buy homes in our towns. Graduates might find employment here, rather than having to move out of the area to find work. A growing community could better attract doctors, dentists, and other health care professionals. School enrolment will grow, and with this growth schools could provide wider program options.

We are aware that there are those that oppose this development on the premise that there will be certain nuisances. We believe in our discussion with the company representatives that they are well attuned to these factors and will work diligently to mitigate any problems that should arise. Currently, they co-exist with other British Colombian neighbors and enjoy healthy relations with these communities.

Finally, we wish to speak to the nature of this business and its environmental impact. The biomass material used in the construction of the pellet is largely waste from the surrounding mills. Drayton Valley's mill (and they are not the exception) is burdened with a large stockpile of waste material that otherwise would only continue to grow. No longer will we have the need to burn the large brush piles, as most of the product can be used. The facility will consume all waste wood that is largely free of dirt. The final product will be used in the production of cleaner energy, helping to replace fossil fuels.

In conclusion, our Chamber is excited about the prospects this development could bring about. We have watched as large developments occurred in the Acheson Industrial Park, while development in the west end of Parkland County lagged far behind. This is a very good opportunity to inject a shot of adrenalin into our economy. The positive effects on our community, our economy and the environment easily outweigh the minimal negative aspects. We urge this council to make the necessary moves to ensure this development happens in Entwistle.

Respectfully submitted,

A handwritten signature in black ink, appearing to read 'Wes Craddock', with a long horizontal flourish extending to the right.

*Wes Craddock, President
Evansburg and Entwistle Chamber of Commerce*

PARKLAND COUNTY NOTICE OF PUBLIC HEARING

In accordance with the requirements of Section 606 of the Municipal Government Act, as amended, the Council of Parkland County has scheduled a Public Hearings regarding the proposed adoption of the following Bylaw(s):

Date: March 28, 2017
Time: 9:30 a.m.
Location: County Council Chambers

Proposed Bylaw No. 2017-05: New Land Use District: AGI-Agricultural Development District

A new land use district, the "AGI - Agricultural Industry Development District" that accommodates specialized agricultural development in rural Parkland County is proposed to be added to the Land Use Bylaw No. 20-2009. It would allow for more intensive value added agricultural and alternative energy production in rural areas within the County. The proposed district adds the General Industrial/Processing use as permitted within the AGI District where it is not currently permitted in the AGR District when the proposed use:

- supports value added agricultural production;
- provides for generation of alternative energy; or
- provides inputs that directly support the aforementioned sectors, such as biomass.

Any proposed Agricultural Industrial Development must reasonably mitigate impacts to adjacent residences and only be permitted where appropriate.

Date: March 28, 2017
Time: 9:45 a.m.
Location: County Council Chambers

Purpose of Proposed Bylaw No. 2017-03: Entwistle Area Structure Plan Amendments

Amendments to the Entwistle Area Structure Plan Bylaw No. 23-2012 are proposed to introduce more diversity in the types of value added agricultural and agricultural industrial uses to support the Hamlet in the following ways:

- Identifies the need for a range of new value added, agricultural-based industrial and alternative energy-based developments.
- Identifies the CN Railway as an asset and as a catalyst for development.
- Provides accommodation for new agricultural, alternative energy, and agricultural industrial based development in rural and fringe areas.
- Provides direction and clarification for the requirements for Outline Plans, Conceptual Plans and Traffic Impact Assessments to support development proposals.
- Requires compliance with County policies around Dark Sky lighting.
- Provides criteria to ensure the use is appropriate for the location and that nuisances are mitigated by the applicant.

Purpose of Proposed Bylaw No. 2017-04: Redistricting of Pt: NW-21-7-5-W5M

The proposed redistricting changes the subject parcel located at NW-21-7-5-W5M from AGR-Agriculture Restricted District to AGI-Agricultural Industrial Development District. This will allow for a "General Industrial" land use on the site for the purpose of developing a wood pellet processing facility.

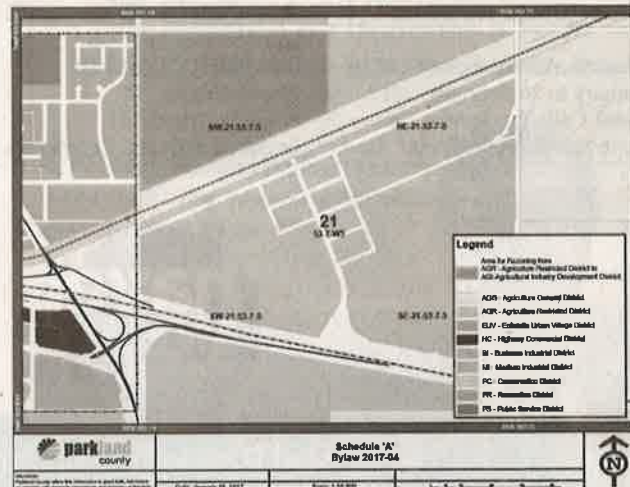

Hearing Procedure

This is a formal Public Hearing and Council is prepared to hear and receive formal submissions and presentations (verbal or written) from those who wish to speak to the proposed Bylaw(s). Written submissions or presentations may be submitted to Planning & Development Services by 4:00 p.m., March 17, 2017 or submitted at the commencement of the Public Hearing. Anyone wishing to make a verbal presentation must notify Planning & Development Services by 4:00 p.m., March 23, 2017. Verbal presentations at the Public Hearing will be limited to a maximum of 10 minutes. Anyone wishing to make a verbal presentation who has not made prior arrangements may be allocated a time at the commencement of the Public Hearing. Council advises that this is your last opportunity to comment on the proposed Bylaw(s) as Council is unable to receive further submissions after the Public Hearing is closed.

Copies of Proposed Bylaw(s)

Copies of the proposed Bylaw(s) are available free of charge during regular business hours (8:30 a.m. to 4:30 p.m., Monday to Friday) from Planning & Development Services at the Parkland County Centre. If you have any questions or wish to present a written or verbal submission, please contact Karen Oxley, Planner with Planning & Development Services at 780-968-8443.